

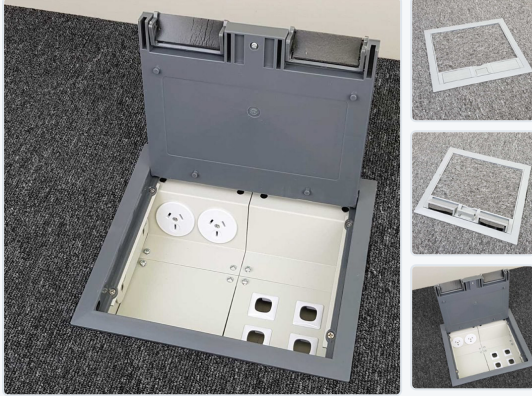

FLOOR OUTLET BOXES & FLOOR BOXES

2 Power Plastic Lid Floor Outlet Box

FBPL2P4D



The FBPL2P4D floor outlet box features a plastic flush lid, providing 2 power and 4 data provisions for comprehensive connectivity. Built for reliable in-floor service delivery in commercial and residential projects.

TECHNICAL SPECIFICATIONS

| | |
|----------------------|---------------------------------|
| Part Number | FBPL2P4D |
| Lid Type | Flush Finish |
| Lid Finish | Plastic |
| Carcass Type | Standard Depth (90 mm) |
| Outlet Configuration | 2 × Power + 4 × Data provisions |
| Body Material | Powder Coated Zinc Anneal Steel |
| Lid Material | Polycarbonate |
| Conduit Knockouts | 25 mm (10) |
| Weight | 3.5 kg (approx.) |

DIMENSIONS

Body: W 194 x L 227 x D 111 mm including lid

LID WIDTH
220 mm

LID LENGTH
250 mm

BODY WIDTH
194 x 227 mm

BODY DEPTH
90 mm

KEY FEATURES

- Plastic flush finish lid — precise alignment with any floor surface
- Powder coated zinc anneal steel body for durability and corrosion resistance
- 25 mm (4 sides) conduit knockouts for flexible cable routing
- 2 power + 4 data provisions — single-box AV and power solution
- Height-adjustable lid mechanism for perfect flush with floor finish
- Suitable for concrete, timber, and raised floor installations

TYPICAL APPLICATIONS

Commercial offices & open plan workspaces

Conference rooms & boardrooms

Retail & showroom fit-outs

Hospitality & hotels

Educational facilities

Residential installations

ORDERING INFORMATION

| | |
|-------------|------------------------------------|
| Part Number | FBPL2P4D |
| Series | Standard Series Floor Outlet Boxes |
| Warranty | Manufacturer's warranty |