

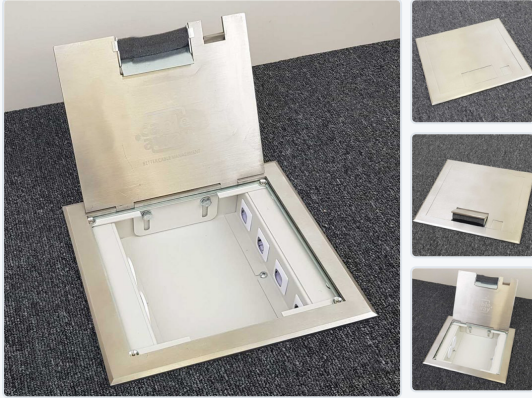

FLOOR OUTLET BOXES & FLOOR BOXES

Shallow Floor Box Stainless Steel Flush complete with 2 x power 4 x Data Shallow Carcass

FBSSF2P4DS50



The FBSSF2P4DS50 floor outlet box features a stainless steel flush lid, providing 2 power and 4 data provisions for comprehensive connectivity. The shallow 54 mm depth suits installations where floor depth is limited. Built for reliable in-floor service delivery in commercial and residential projects.

TECHNICAL SPECIFICATIONS

Part Number	FBSSF2P4DS50
Lid Type	Flush Finish
Lid Finish	Stainless Steel
Carcass Type	Shallow Depth (50 mm)
Outlet Configuration	2 x Power + 4 x Data provisions
Body Material	Powder Coated Zinc Anneal Steel
Lid Material	Stainless Steel
Conduit Knockouts	25 mm (12)
Weight	4.0 kg (approx.)

DIMENSIONS

Body: W 194 x L 227 x D 54 mm to underside of lid

LID WIDTH
220 mm

LID LENGTH
250 mm

BODY WIDTH
194 x 227 mm

BODY DEPTH
50 mm

KEY FEATURES

- Stainless Steel flush finish lid — precise alignment with any floor surface
- Powder coated zinc anneal steel body for durability and corrosion resistance
- 25 mm (4 sides) conduit knockouts for flexible cable routing
- 2 power + 4 data provisions — single-box AV and power solution
- Shallow 54 mm body depth — ideal for limited-depth floor installations
- Height-adjustable lid mechanism for perfect flush with floor finish
- Suitable for concrete, timber, and raised floor installations

TYPICAL APPLICATIONS

Commercial offices & open plan workspaces

Conference rooms & boardrooms

Retail & showroom fit-outs

Hospitality & hotels

Educational facilities

Residential installations

ORDERING INFORMATION

Part Number	FBSSF2P4DS50
Series	Standard Series Floor Outlet Boxes
Warranty	Manufacturer's warranty